

SPECIFICATIONS :

- . Between claws 41mm
- . NFE 29573 standards

USE :

- . Water and comprimed air
- . Max temperature Ts : 60°C
- . Max pressure Ps : 10 bars

MATERIALS :

DESIGNATION	MATERIALS
Body	Brass
Gasket	NBR

SIZE :

. Hose coupler Ref. 2280 (with mounted gasket) - Ref. 2285 (without gasket)

	D	7	9	11	13	16	19	22	25
Ref.	L	69	69,0	69	69	69	69	69	69
2280	L1	40	40	40	40	40	40	40	40
2285	A	22	22	22	22	22	22	22	22
	P	4	6	8	10	12	15	18	21

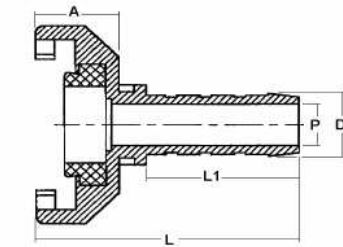

. Male coupler Ref. 2281 (with mounted gasket) - Ref. 2286 (without gasket)

	D	1/4"	3/8"	1/2"	3/4"	1"	1" 1/4
Ref.	L	38	39	42	42	42	47
2281	L1	10,5	11	14	14	14	17
2286	A	22	22	22	22	22	22
	P	8	10	15	20	25	32

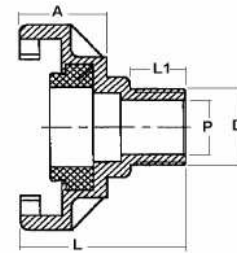

. Female coupler Ref. 2282 (with mounted gasket) - Ref. 2287 (without gasket)

	D	1/4"	3/8"	1/2"	3/4"	1"	1" 1/4
Ref.	L	33	33	33	36	37	42
2282	A	22	22	22	22	22	22
2287							

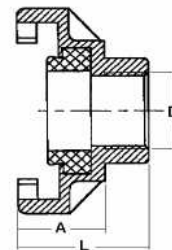

. Cap coupler

Ref. 2283 (with mounted gasket)

Ref. 2288 (without gasket)

