

SPECIFICATIONS :

- "Lost wax" moulding
- Male : BSPT threaded
- Female : BSPP threaded

USE :

- Max pressure Ps : 20 bars

RANGE :

- 1/8" to 4"

MATERIALS :

- Stainless steel ASTM A351 CF8M

SIZE :

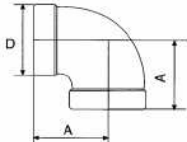

· Elbow 90° F/F Ref. 2001

DN	1/8"	1/4"	3/8"	1/2"	3/4"	1"	1" 1/4	1" 1/2	2"	2" 1/2	3"	4"
A	19	21	25	28	33	38	45	50	58	69	80	97
D	15	19	23	28	34	43	52	57	70	91	107	134

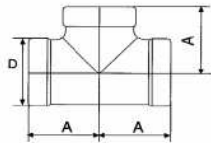

· Tee F/F/F Ref. 2003

DN	1/8"	1/4"	3/8"	1/2"	3/4"	1"	1" 1/4	1" 1/2	2"	2" 1/2	3"	4"
A	19	21	25	28	33	38	45	50	58	69	80	97
D	15	19	23	28	34	42	52	57	70	86	100	125

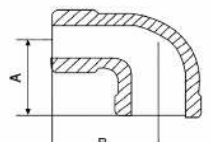

· Elbow 90° M/F Ref. 2010

DN	1/8"	1/4"	3/8"	1/2"	3/4"	1"	1" 1/4	1" 1/2	2"	2" 1/2	3"
A	19	19	23	28	30	36	44	48	55	67	77
B	25	29	35	40	48	53	65	70	77	93	105

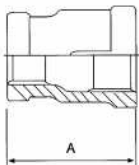

· Reduced nipple female/female Ref. 2013/2014

DN1	1/4"	3/8"	3/8"	1/2"	1/2"	3/4"	3/4"	1"	1"	1" 1/4	1" 1/4	1" 1/2	1" 1/2	2"	2"
DN2	1/8"	1/8"	1/4"	1/4"	3/8"	3/8"	1/2"	1/2"	3/4"	3/4"	1"	1"	1" 1/4	1" 1/4	1" 1/2
A	28,5	40,4	28,6	34,2	44,6	38	37,5	50,5	43	50,7	47,7	58,4	57,6	66,7	100

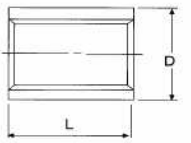

· Socket bright Ref. 2015

DN	1/8"	1/4"	3/8"	1/2"	3/4"	1"	1" 1/4	1" 1/2	2"	2" 1/2	3"	4"
L	17	25	26	34	36	43	48	48	58	65	71	83
D	14	19	22	26	32	40	48	55	66	83	96	122

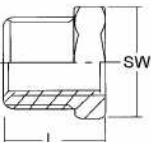

· Reduced nipple male/female Ref. 2021/2024

DN1	1/4"	3/8"	3/8"	1/2"	1/2"	3/4"	3/4"	1"	1"	1" 1/4	1" 1/4	1" 1/2	1" 1/2	2"	2"
DN2	1/8"	1/8"	1/4"	1/4"	3/8"	3/8"	1/2"	1/2"	3/4"	3/4"	1"	1"	1" 1/4	1" 1/4	1" 1/2
L	19	19	19	22	22	26	26	28	28	33	33	35	35	39	39
SW	16	19	19	23	23	28	28	36	36	46	46	50	50	65	65

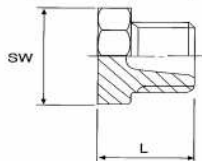

· Hexagon plug Ref. 2022 or 2023 (plain)

DN	1/8"	1/4"	3/8"	1/2"	3/4"	1"	1" 1/4	1" 1/2	2"
L	19	19	19	22	26	28	33	35	39
SW	12	16	19	23	28	36	46	50	65

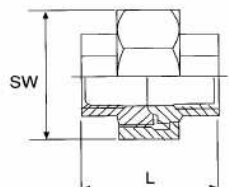

· Union female/female Ref. 2025

DN	1/4"	3/8"	1/2"	3/4"	1"	1" 1/4	1" 1/2	2"
L	31	34	38	42	48	54	58	62
SW	29	34	39	48	58	67	76	90

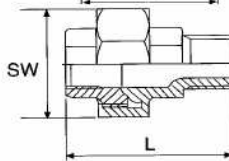

· Union male/female Ref. 2026

DN	1/4"	3/8"	1/2"	3/4"	1"	1" 1/4	1" 1/2	2"
L	44	47	56	60	67	76	81	89
SW	29	34	39	48	58	67	76	90

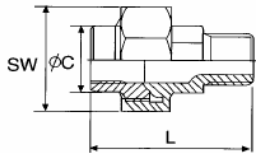

. Welded-screwed union Ref. 2027

DN	3/8"	1/2"	3/4"	1"	1" 1/4	1" 1/2	2"
L	47	55	61	66	74	80	86
SW	34	39	48	58	67	76	90
C	18	22	27	34	42	48	60

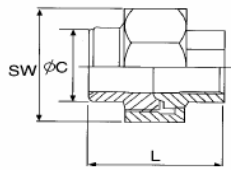

. Welded-threaded union Ref. 2028

DN	3/8"	1/2"	3/4"	1"	1" 1/4	1" 1/2	2"
L	37	42	47	51	57	62	68
SW	34	39	48	58	67	76	90
C	18	22	27	34	42	48	60

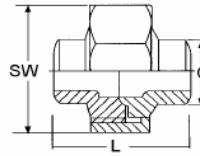

. Welded union Ref. 2029

DN	10	15	20	25	32	40	50
L	41	46	53	55	61	65	73
SW	34	39	48	58	67	76	90
C	18	22	27	34	42	48	60

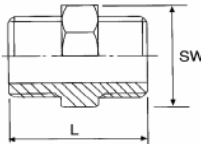

. Hexagon nipple Ref. 2030

DN	1/8"	1/4"	3/8"	1/2"	3/4"	1"	1" 1/4	1" 1/2	2"
L	25	32	37	41	46	50	56	58	65
SW	12	14	20	23	27	36	46	50	65

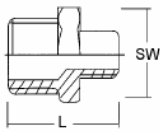

. Reduced nipple male/male Ref. 2031/2032

DN1	1/4"	3/8"	3/8"	1/2"	1/2"	3/4"	3/4"	1"	1"	1" 1/4	1" 1/4	1" 1/2	1" 1/2	2"	2"
DN2	1/8"	1/8"	1/4"	1/4"	3/8"	3/8"	1/2"	1/2"	3/4"	3/4"	1"	1"	1" 1/4	1" 1/4	1" 1/2
L	31	35	35	38	38	41	41	47	47	53	53	56	56	64	64
SW	17	19	19	23	23	29	29	37	37	46	46	54	54	65	65

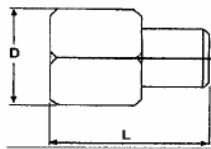

. Reduced nipple female/male Ref. 2033

DN	1/4"	3/8"	1/2"	3/4"	1"	1" 1/4	1" 1/2	2"
DN	1/8"	1/4"	3/8"	1/2"	3/4"	1"	1" 1/4	1" 1/2
L	27	30	35	39	44	47	50	53
D	17	21	26	32	38	46	54	63

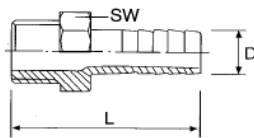

. Hose nozzle Ref. 2035

DN	1/4"	3/8"	1/2"	3/4"	1"	1" 1/4	1" 1/2	2"
L	47	51	56	67	71	75	90	99
SW	15	19	23	29	38	46	52	63
D	8,9	11,5	14	19,5	26	34	40	52

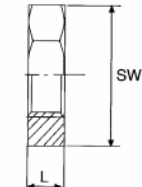

. Hexagon nut Ref. 2036

DN	1/8"	1/4"	3/8"	1/2"	3/4"	1"	1" 1/4	1" 1/2	2"
L	6	6	7	8	9	10	11	12	13
SW	19	22	27	32	37	46	55	62	76

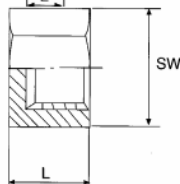

. Hexagon cap female Ref. 2037

DN	1/4"	3/8"	1/2"	3/4"	1"	1" 1/4	1" 1/2	2"
L	15	17	19	23	26	28	30	34
SW	18	22	26	32	39	48	54	69

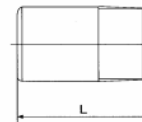

. Standard welding nipple Ref. 2039

DN	1/4"	3/8"	1/2"	3/4"	1"	1" 1/4	1" 1/2	2"	2" 1/2	3"	4"
L	30	30	35	40	40	50	50	50	60	70	80

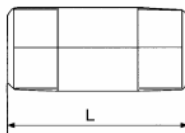

. Standard barrel nipple Ref. 2040

DN	1/4"	3/8"	1/2"	3/4"	1"	1" 1/4	1" 1/2	2"	2" 1/2	3"	4"
L	40	40	60	60	60	80	80	100	100	120	120

SPECIFICATIONS :

- . Threaded BSPP female
- . Threaded BSPT male
- . Conical bearing

USE :

- . Max pressure Ps : 60 bars

RANGE :

- . 1/4" to 2"

MATERIALS :

- . Stainless steel 316L

SIZE :

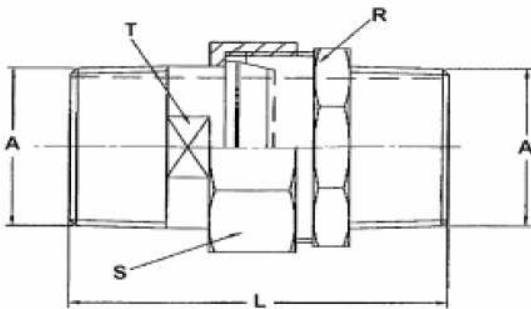

Union male/male Ref. 2064

DN	3/8"	1/2"	3/4"	1"	1" 1/4"	1" 1/2"	2"
A	3/8"	1/2"	3/4"	1"	1" 1/4"	1" 1/2"	2"
S	24	30	36	46	55	60	70
R	22	28	35	43	52	57	68
T	14	18	24	30	38	45	54
L	57	66	71	80	82	85	95

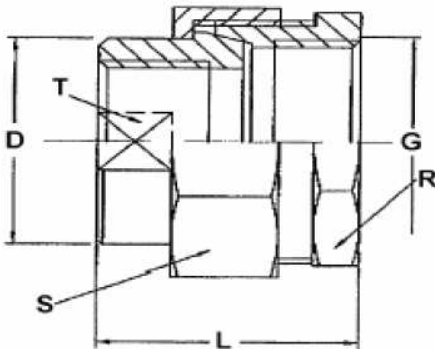

Union female/female Ref. 2065

DN	1/4"	3/8"	1/2"	3/4"	1"	1" 1/4"	1" 1/2"	2"
D	17,2	21,3	26,9	33,7	42,4	48,3	60,3	66
G	1/4"	3/8"	1/2"	3/4"	1"	1" 1/4"	1" 1/2"	2"
S	24	30	36	46	55	60	70	84
R	22	28	35	43	52	57	68	78
T	15	19	24	30	38	45	54	63
L	29	34	34	38	44	50	53	54

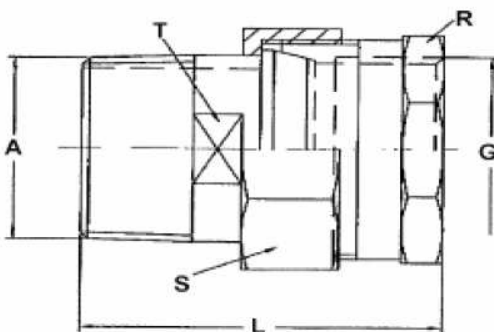

Union male/female Ref. 2066

DN	1/4"	3/8"	1/2"	3/4"	1"	1" 1/4"	1" 1/2"	2"
A	1/4"	3/8"	1/2"	3/4"	1"	1" 1/4"	1" 1/2"	2"
G	1/4"	3/8"	1/2"	3/4"	1"	1" 1/4"	1" 1/2"	2"
S	21	24	30	36	46	55	60	70
R	18	22	28	35	43	52	57	68
T	11	14	18	24	30	38	45	54
L	41	45	54	57	66	70	73	83

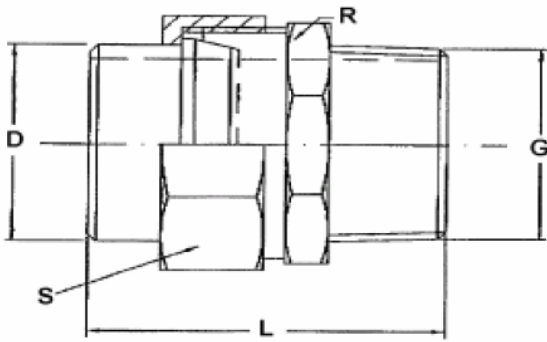

Welded/male union Ref. 2067

DN	3/8"	1/2"	3/4"	1"	1" 1/4	1" 1/2	2"
D	17,2	21,3	26,9	33,7	42,4	48,3	60,3
G	3/8"	1/2"	3/4"	1"	1" 1/4	1" 1/2	2"
S	24	30	36	46	55	60	70
R	22	28	35	43	52	57	68
L	47	52	59	64	65	65	73

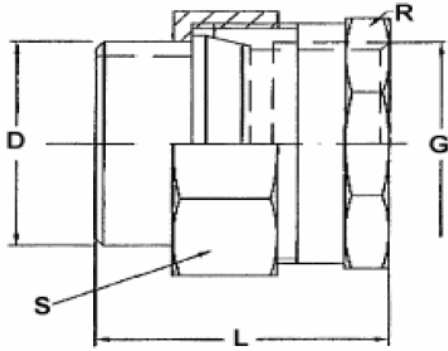

Welded/female union Ref. 2068

DN	3/8"	1/2"	3/4"	1"	1" 1/4	1" 1/2	2"
D	17,2	21,3	26,9	33,7	42,4	48,3	60,3
G	3/8"	1/2"	3/4"	1"	1" 1/4	1" 1/2	2"
S	24	30	36	46	55	60	70
R	22	28	35	43	52	57	68
L	35	40	45	50	53	53	61

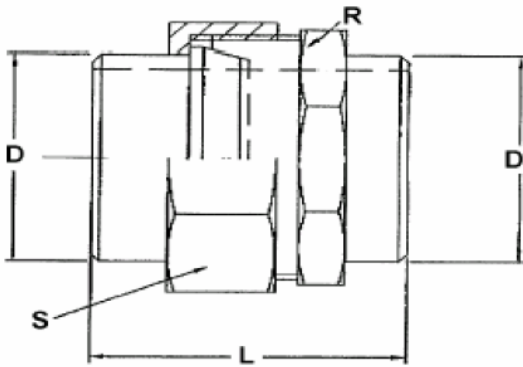

BW/BW union Ref. 2069

DN	10	15	20	25	32	40	50
D	17,2	21,3	26,9	33,7	42,4	48,3	60,3
S	24	30	36	46	55	60	70
R	22	28	35	43	52	57	68
L	45	48	52	55	56	58	62